

# laevo



EN

**V2.57**

Wearable back support  
for repetitive bending and  
bended posture

**Quick Guide**

August 2020

For USA and Canada

# Safety instructions & application

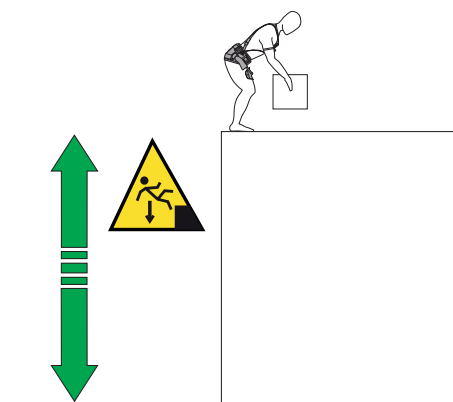
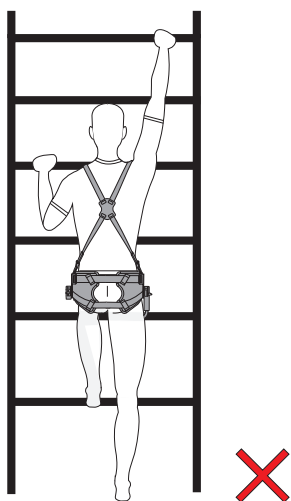
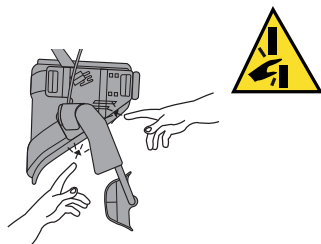
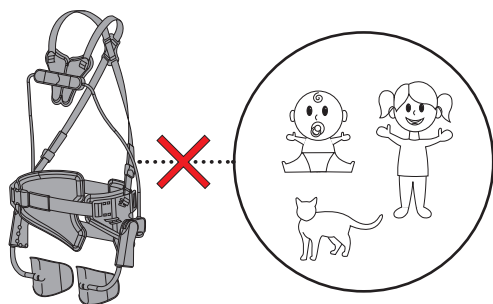
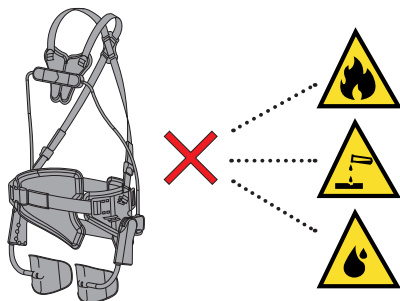

# Installation

## QG-1

EN

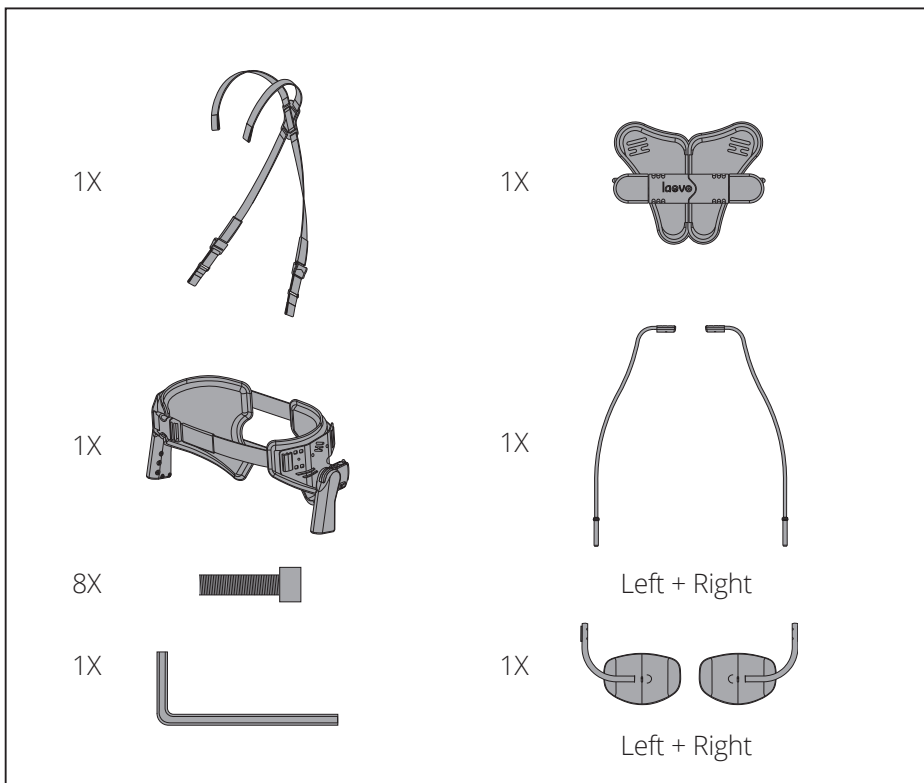
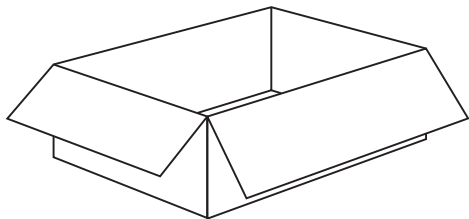

# Installation

## QG-2

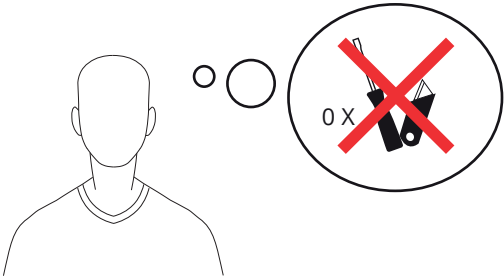
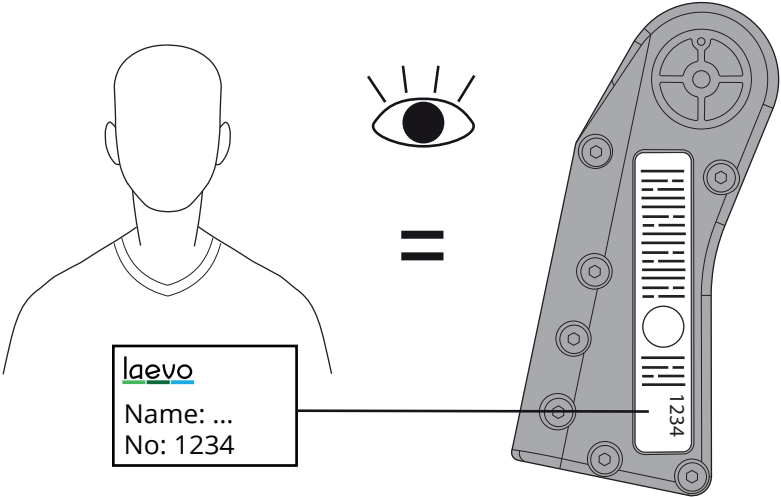

# Installation

QG-3

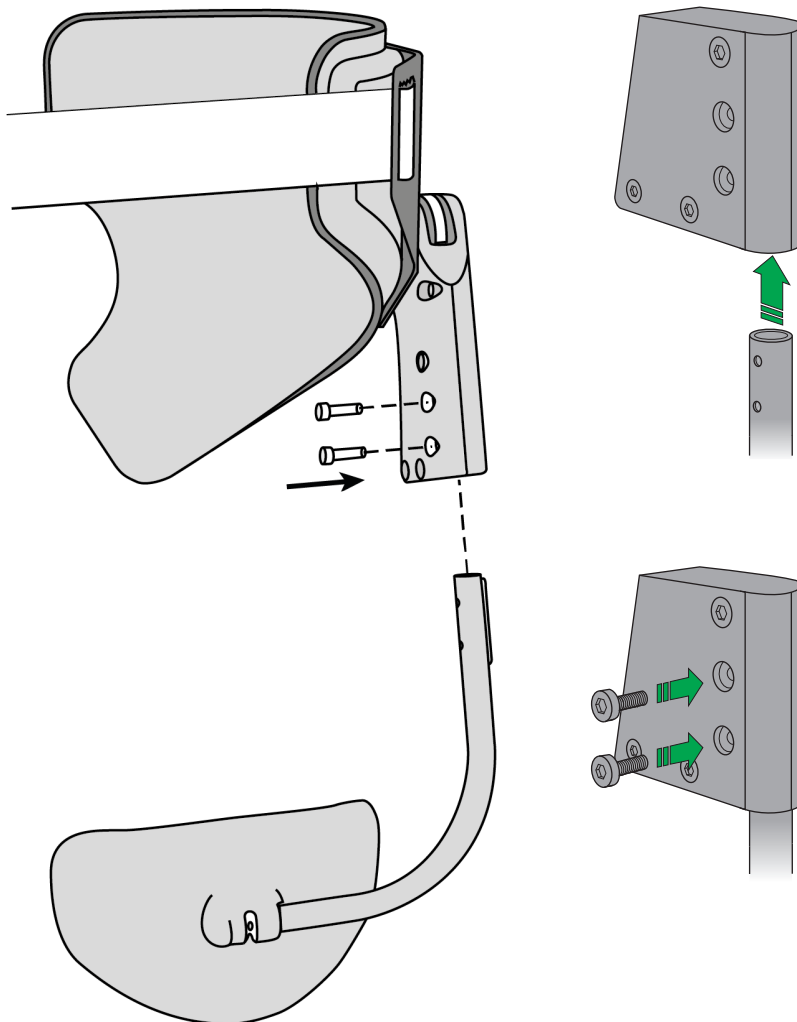

EN



# Installation

## QG-4

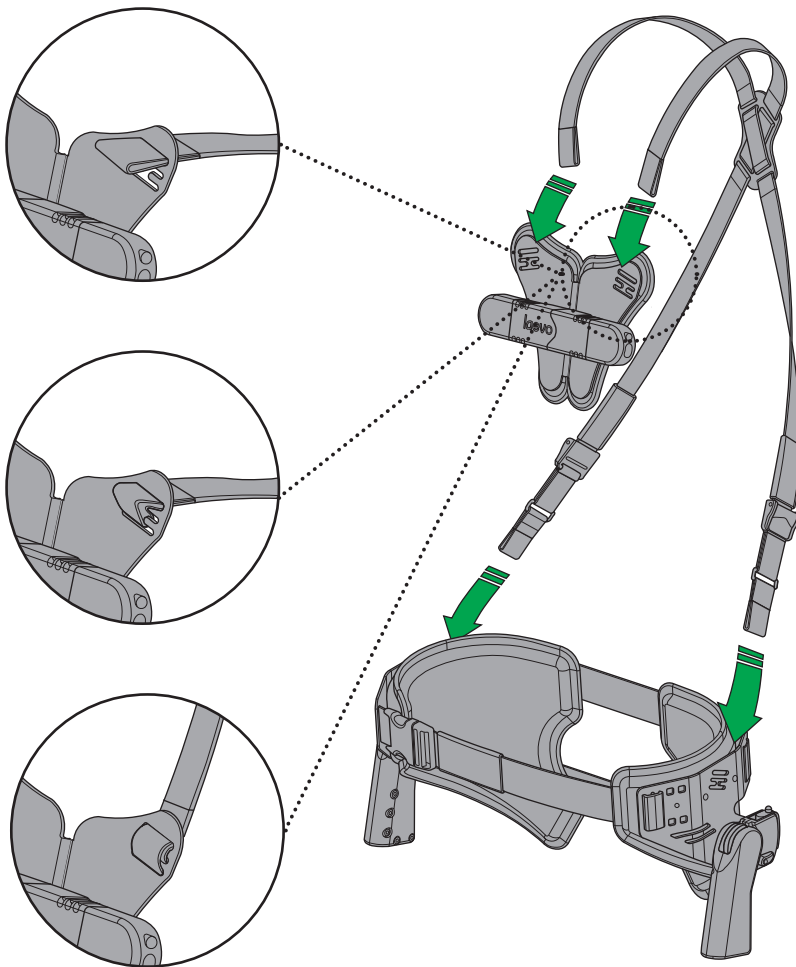

# Installation

QG-5

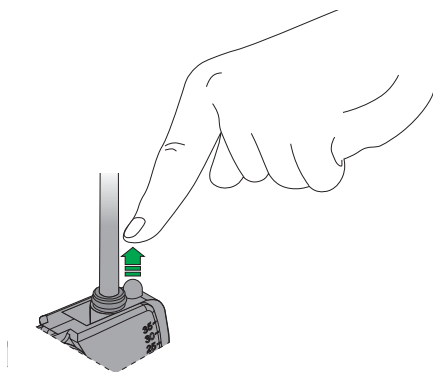
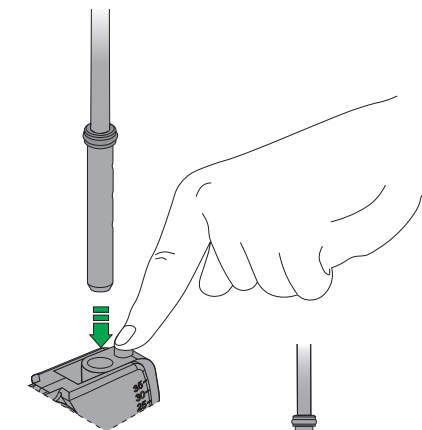
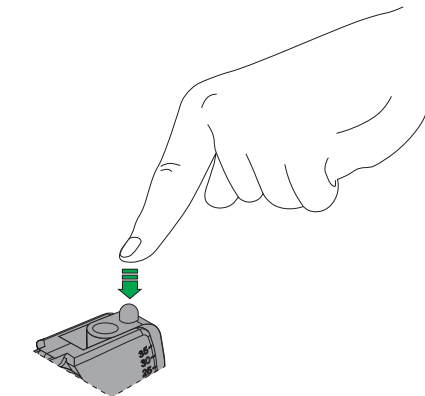
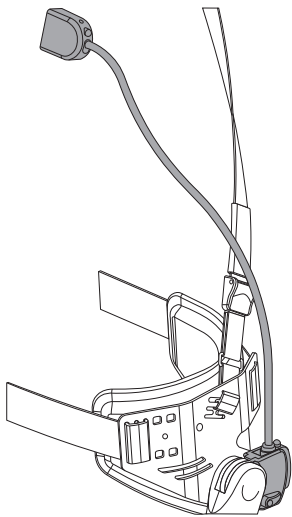

EN



# Installation

QG-6

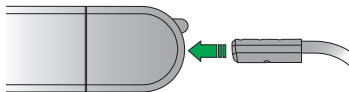
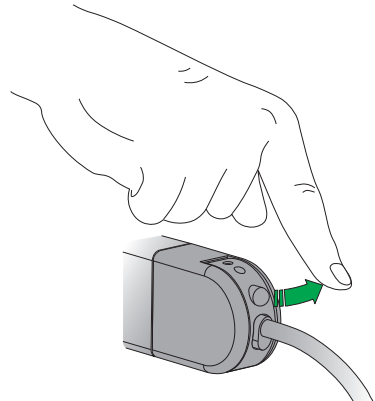
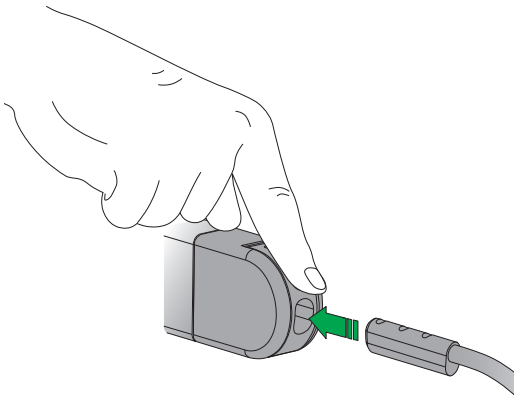
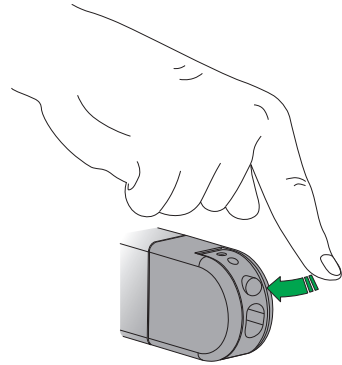
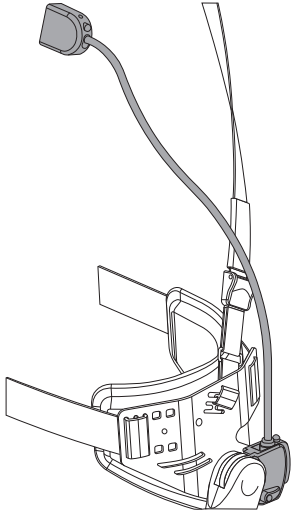



# Fitting

## QG-7

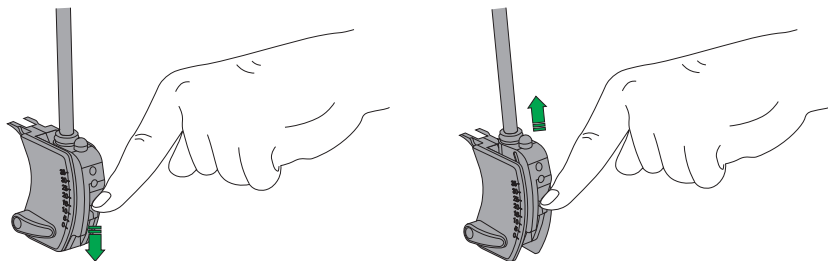

## QG-8

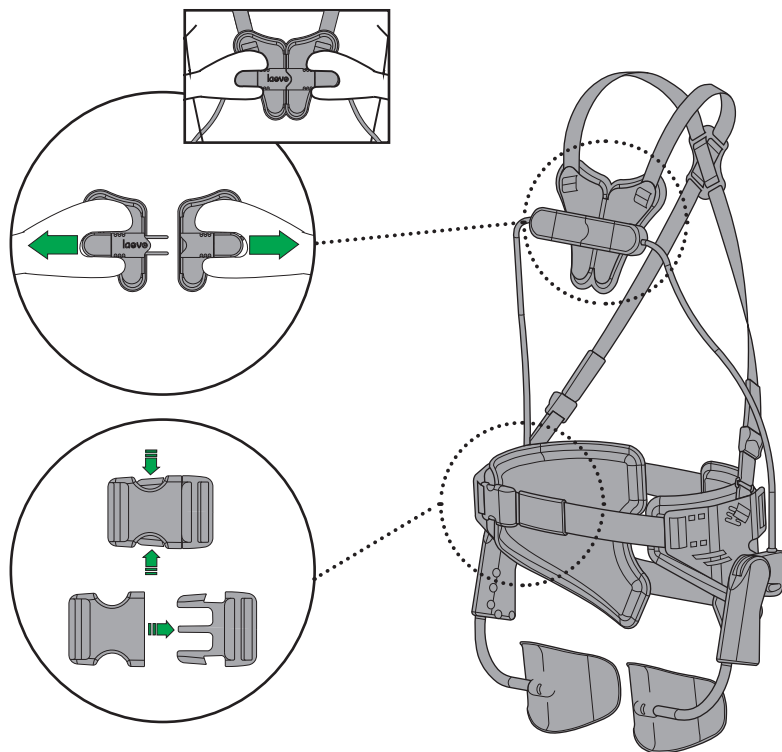

# Fitting

## QG-9

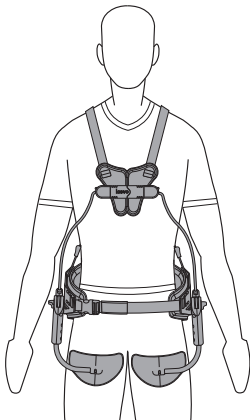
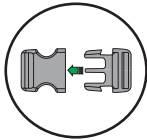
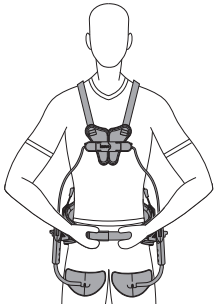
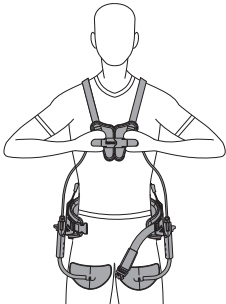
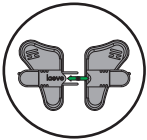
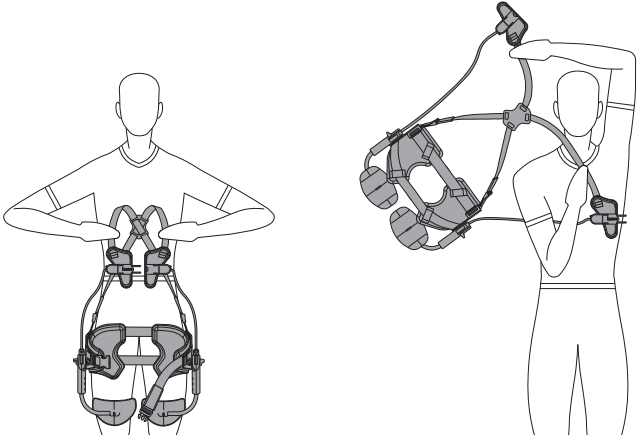

# Fitting

QG-10

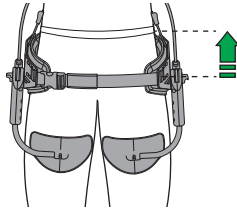

EN

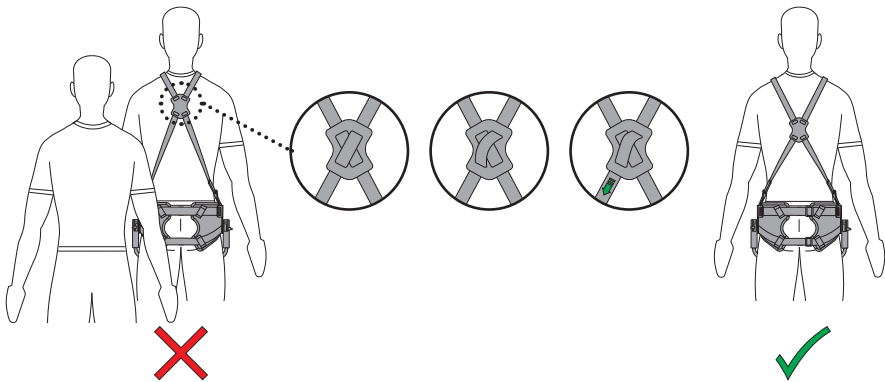
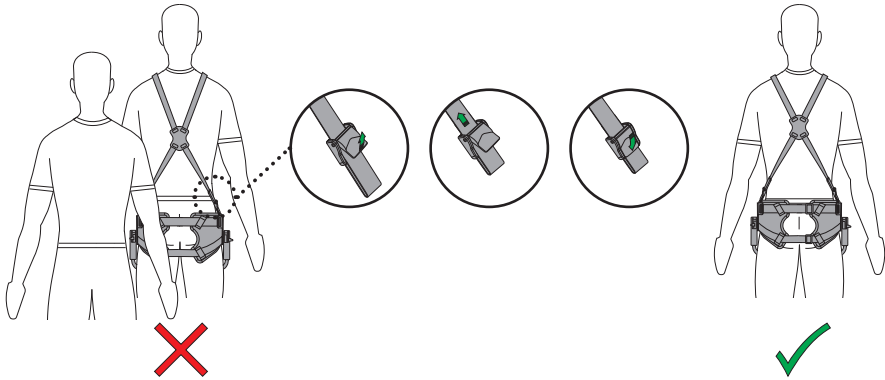

# Fitting

QG-11

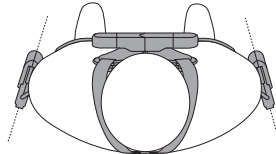
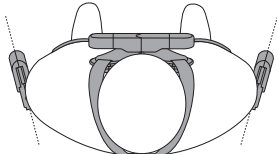
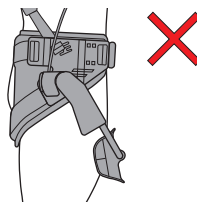
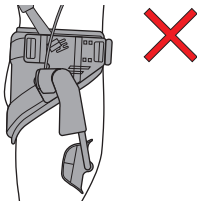
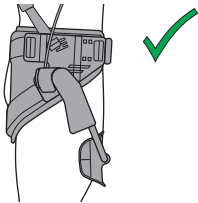
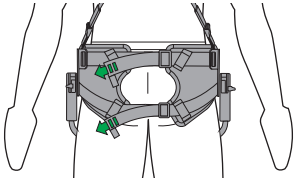

# Fitting

## QG-12

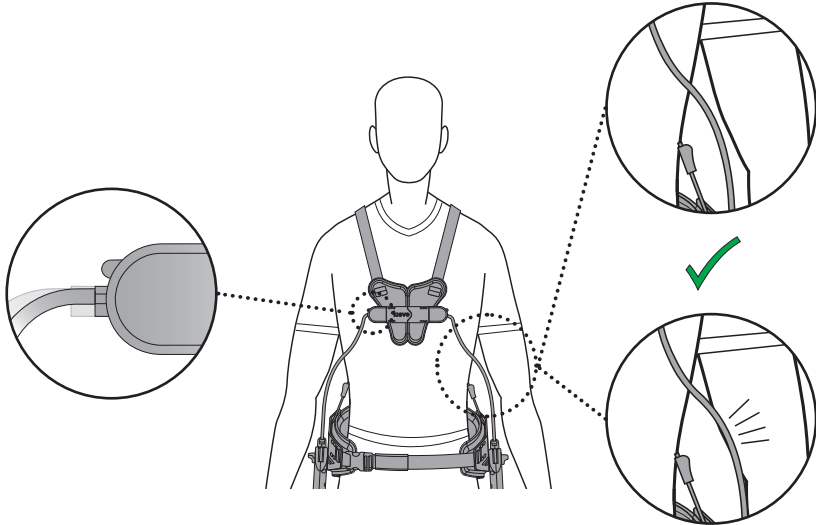

## QG-13

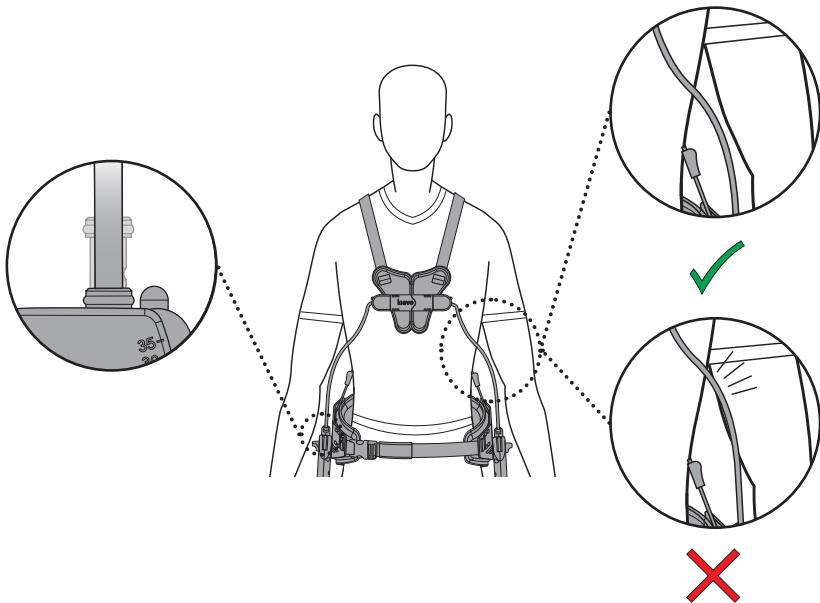

# Fitting

## QG-14

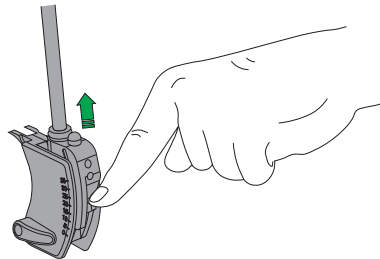
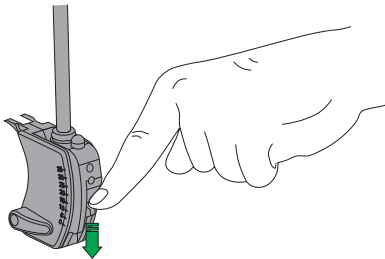
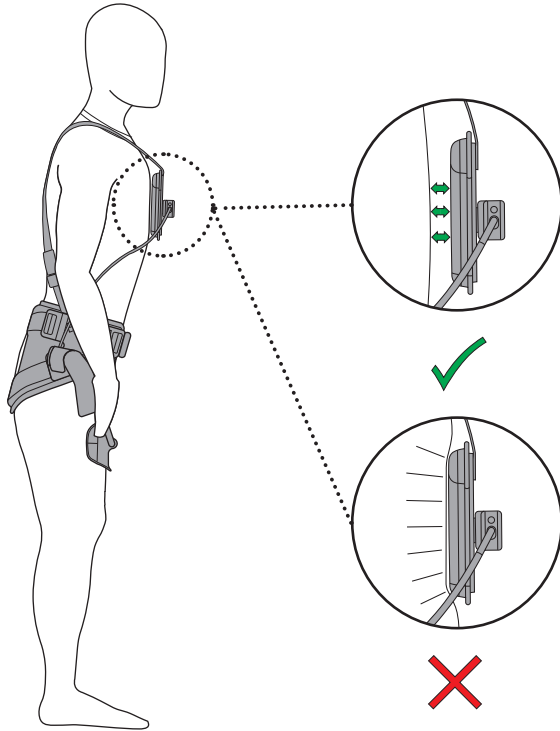

# First use

QG-15

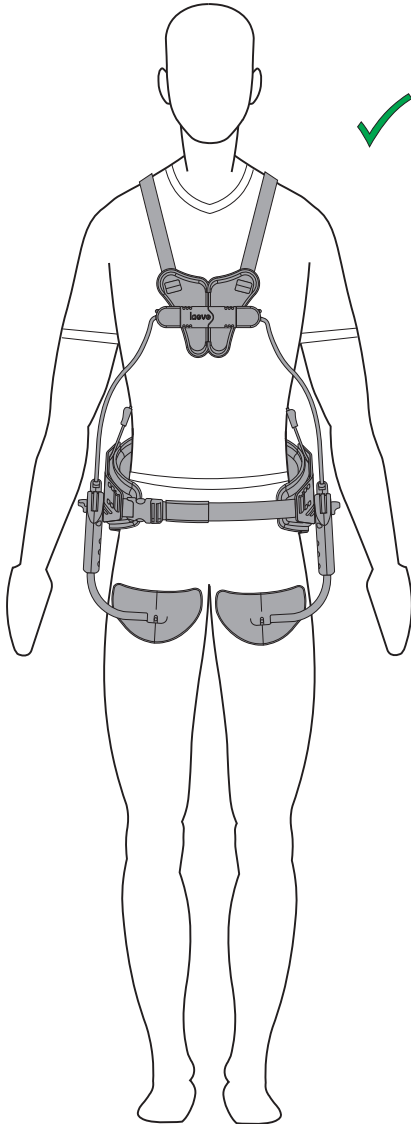

QG-16

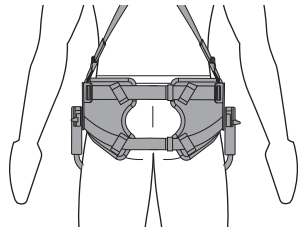
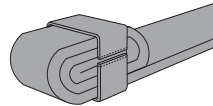
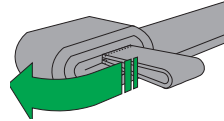
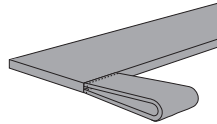
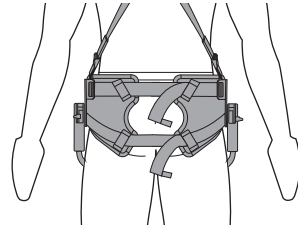

# Checks

## QG-A

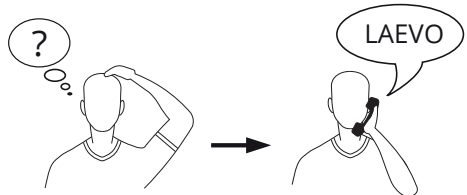
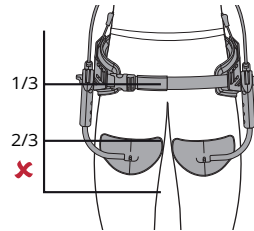
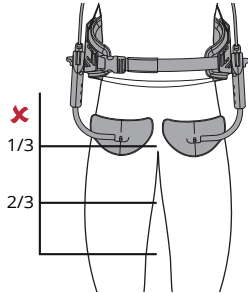
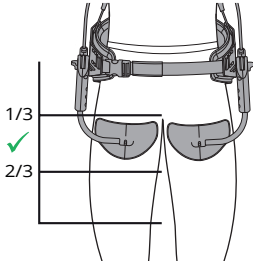
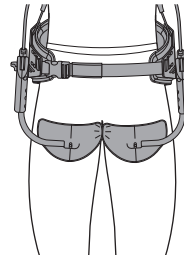
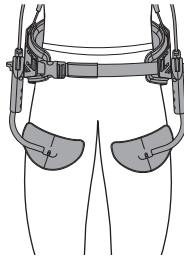
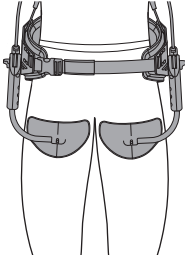



# Checks

QG-B

EN

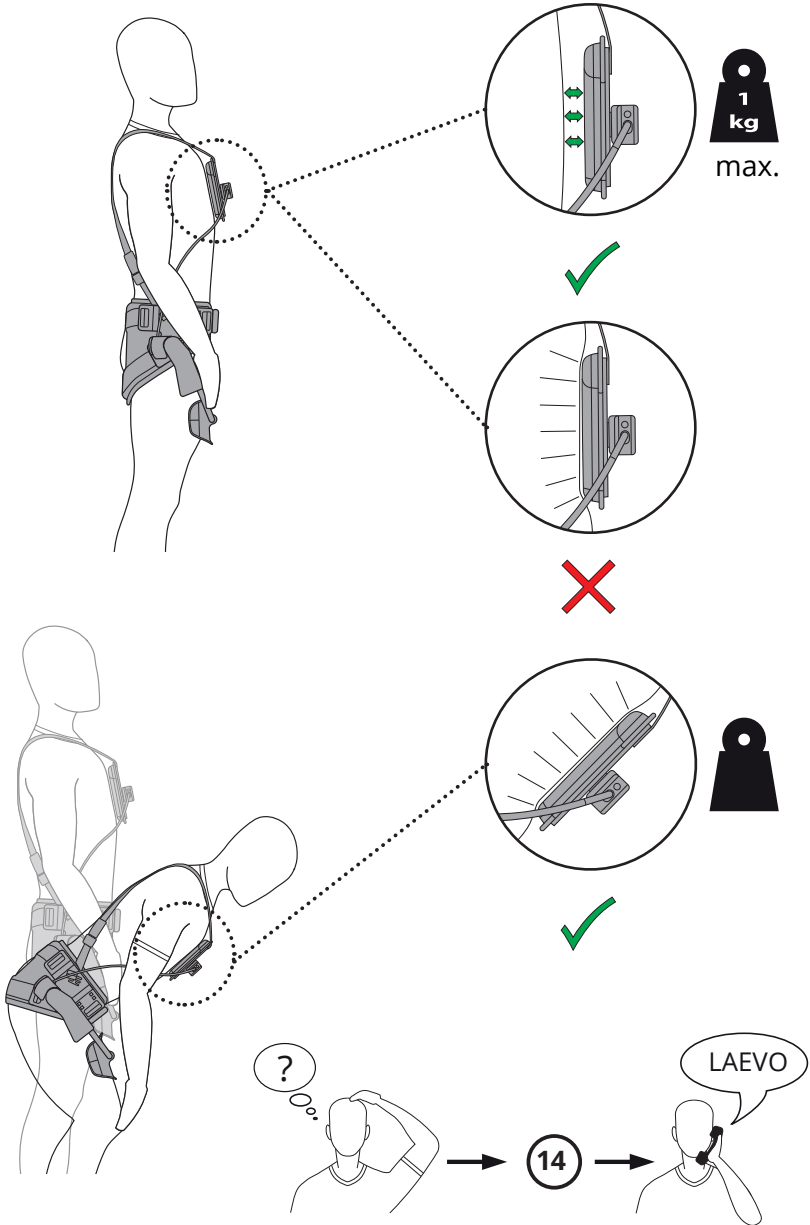

# Checks

## QG-C

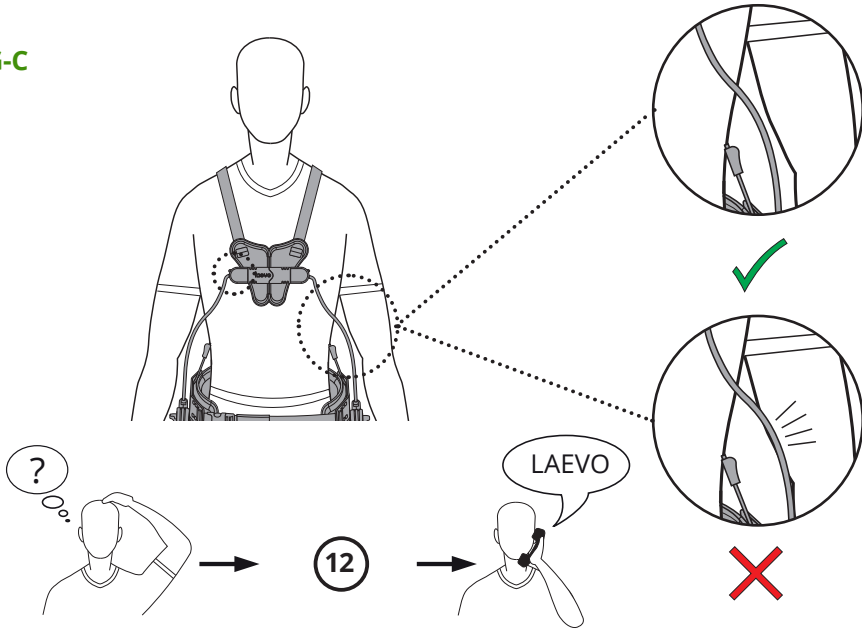

## QG-D

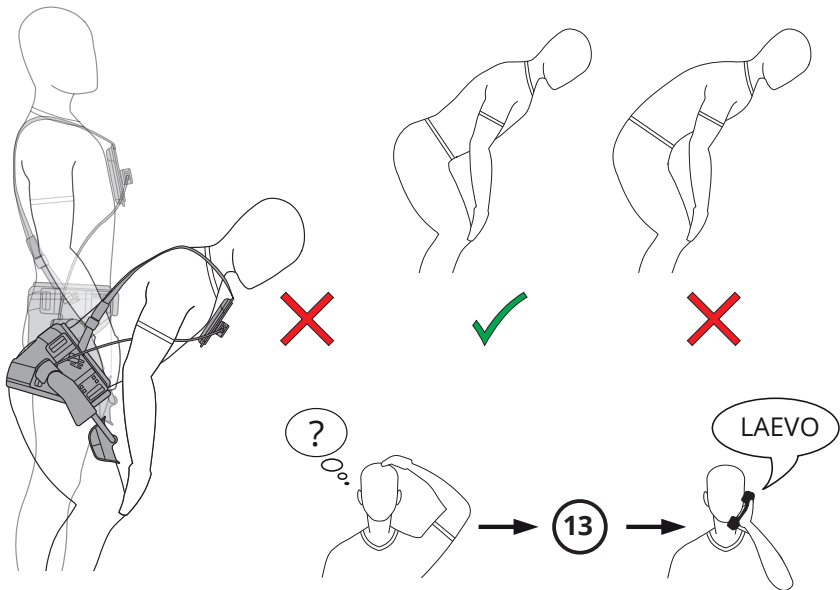

# Daily use

## QG-I

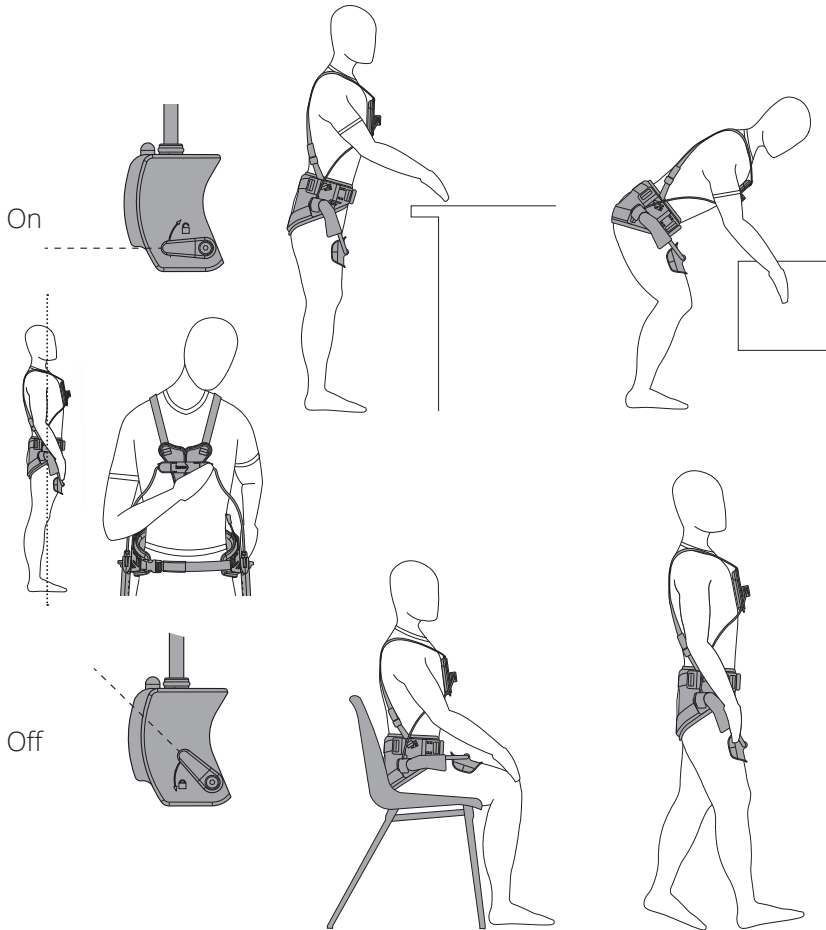

EN

## QG-II

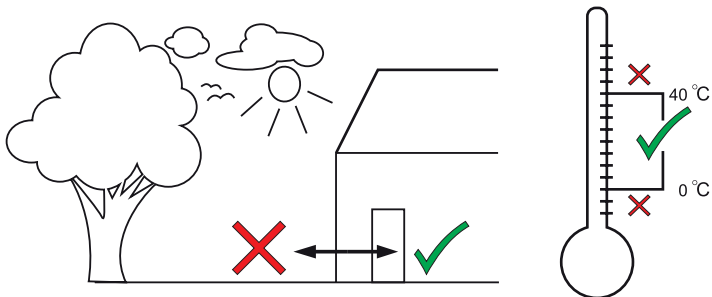

# Daily use

## QG-III

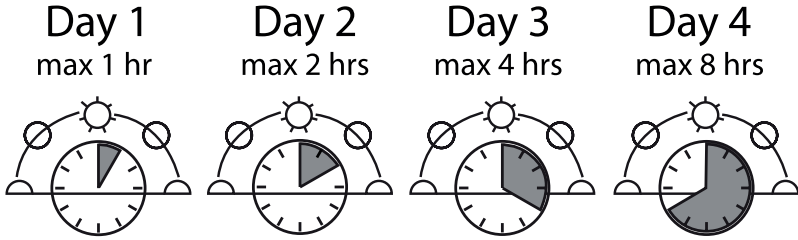

## QG-IV

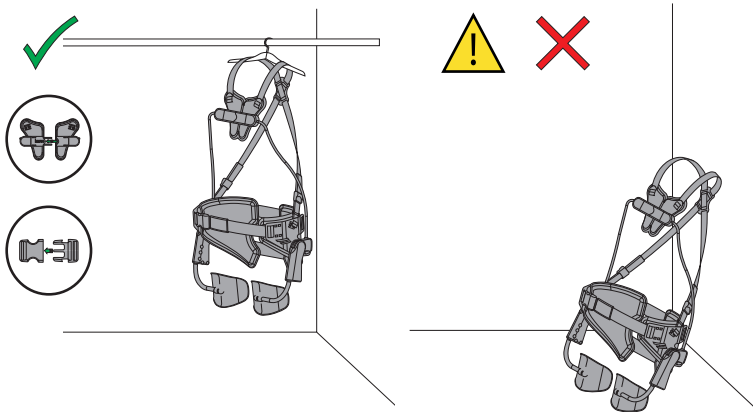

# Contact

---

Laevo B.V.  
Patrijsweg 30  
2289 EX Rijswijk  
The Netherlands  
[www.laevo.nl](http://www.laevo.nl)  
+31 15 30 20 025  
[info@laevo.nl](mailto:info@laevo.nl)

EN

